



HILTON ARUBA CARIBBEAN RESORT & CASINO MEETING AND EVENT FACTS

AT A GLANCE

- Designated AAA four-diamond resort
- Located just 7 miles from the airport
- 24,000 square feet of flexible outdoor event space ranging from gardens to beach
- Renovated 15,000 square foot indoor meeting space with grand ballroom and meeting rooms
- The 8,100 square foot flexible Morris Lapidus Grand Ballroom
- 5 private breakout meeting rooms
- Complimentary standard Wi-Fi

Discover Hilton Aruba Caribbean Resort & Casino, where modern elegance blends with the spirit of Aruba. Featuring a breathtaking location on 15 tropical acres along Palm Beach, steps away from nightlife, shopping, dining, this world-class resort is the perfect place for your next meeting or event.

Experience endless ocean vistas and a diverse selection of bars and restaurants, including our traditional steakhouse, Sunset Grille, Gilligan's Seafood Shack and Mira Solo Lobby Bar.

With a legacy dating back to 1959, the resort features a wide variety of activities and amenities, including water sports, a kids' club, a nearby butterfly house and exotic wellness journeys in our beachfront eforea™ spa.



**HILTON ARUBA CARIBBEAN
RESORT & CASINO**

[HILTONARUBA.COM](https://www.hiltonaruba.com)

J.E. Irausquin Blvd. 81, Palm Beach, Aruba
800 250 0134 | +297 586 6555
auahh-salesadm@hilton.com

CAPACITIES & DIMENSIONS



	Square Footage	Dimensions W x L	Banquet Style	Theater Style	Square Style	Conference Style	Reception Style	School Style	U-Shape Style	Cabaret Style
Ballrooms										
Salon A, B & C (Ballroom)	8,103'	111' x 73'	135	128	50	32	300	119	34	90
Salon A	2,701'	37' x 73'	45	45	26	22	90	36	22	30
Salon B	2,701'	37' x 73'	45	45	26	22	90	36	22	30
Salon C	2,701'	37' x 73'	45	45	26	22	90	36	22	30
Salon A & B or B & C	5,402'	74' x 73'	90	80	38	22	190	72	28	60
Meeting Rooms										
Meeting Room 1	665'	19' x 35'	12	12	10	10	12	12	8	12
Meeting Room 2	700'	20' x 35'	12	12	10	10	12	12	8	12
Meeting Room 3	665'	19' x 35'	12	12	10	10	12	12	8	12
Meeting Room 4	1,026'	27' x 38'	12	12	10	10	18	12	8	12
Meeting Room 5	1,026'	27' x 38'	12	12	10	10	18	12	8	12
Foyer	3,200'	-	-	-	-	-	60	-	-	-
Outdoor Venues										
Sunset Terrace	2,278'	34' x 67'	36	-	-	-	60	-	-	26
Miramar North (Grass Lawn)	3,432'	52' x 66'	32	-	-	-	40	-	-	16
Miramar South (Grass Lawn)	2,907'	57' x 51'	32	-	-	-	40	-	-	16
North Pool Deck	9,392'	-	180	-	-	-	220	-	-	90
South Pool Deck	3,724'	-	32	-	-	-	80	-	-	16
Beach Venues										
Beach Aisle	12,600'	90' x 140'	280	-	-	-	350	-	-	140
South Beach	6,030'	90' x 67'	112	-	-	-	120	-	-	56
Eforea Beach	4,860'	90' x 54'	96	-	-	-	100	-	-	48
Alternative Resort Venues										
Sunset Grille Restaurant	1,617'	49' x 33'	110	-	-	-	150	-	-	-

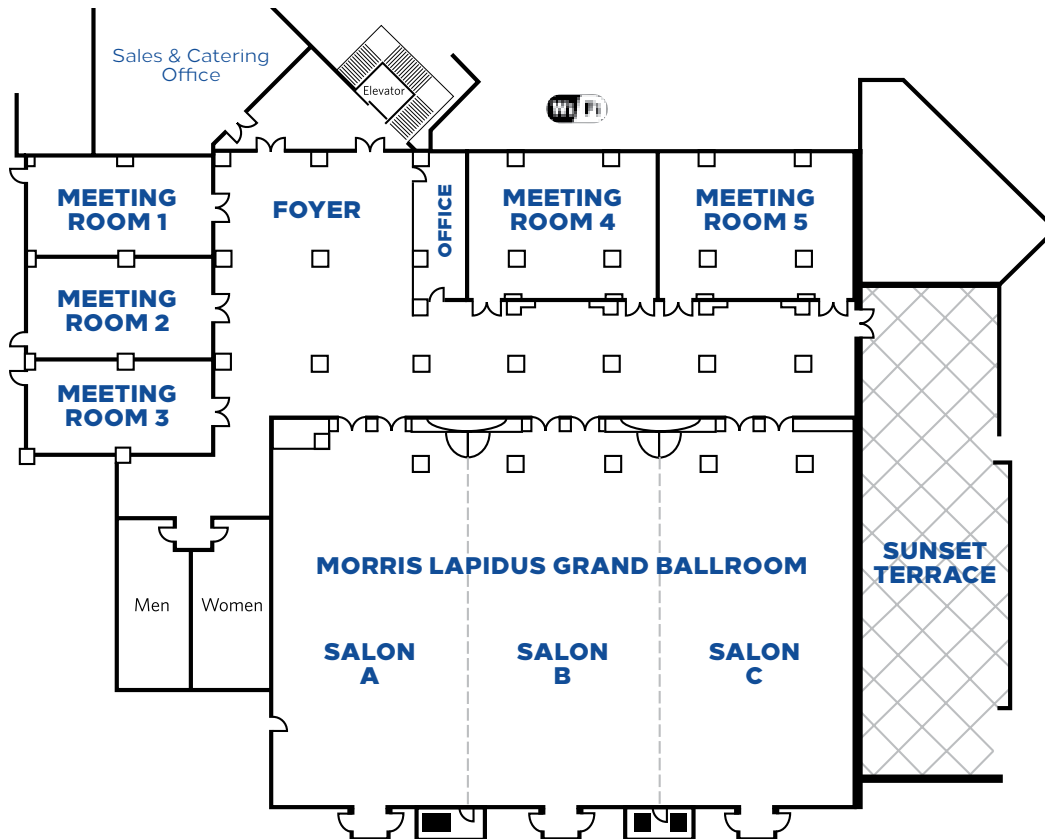

GUEST ROOMS

- 1. Aruba Tower/Palm Beach Club
- 2. Bonaire Tower
- 3. Curaçao Tower

RESTAURANTS & BARS

- 4. Gilligan's Seafood Shack
- 5. Castaways Bar
- 6. Laguna
- 7. Mira Solo Bar
- 8. Oscar's Market
- 9. Sunset Grille

STORES & BOUTIQUES

- 10. Tropical Breeze
- 11. Tropical Flavors

AMENITIES & SERVICES

- 12. Beach
- 13. Curaçao Lobby
- 14. De Palm Concierge / Hertz
- 15. De Palm Pier
- 16. eforea Spa
- 17. Fitness Center
- 18. Main Lobby/Reception
- 19. Parking Lot
- 20. North Pool
- 21. South Pool
- 22. Towel Hut/Activities Center
- 23. Red Sail Aruba (Watersports)
- 24. Bird Garden

MEETING FACILITIES

- 25. Meeting Rooms (Lower Level)

26. THE CASINO ARUBA